

# MIKUNI HS40 TM36-68

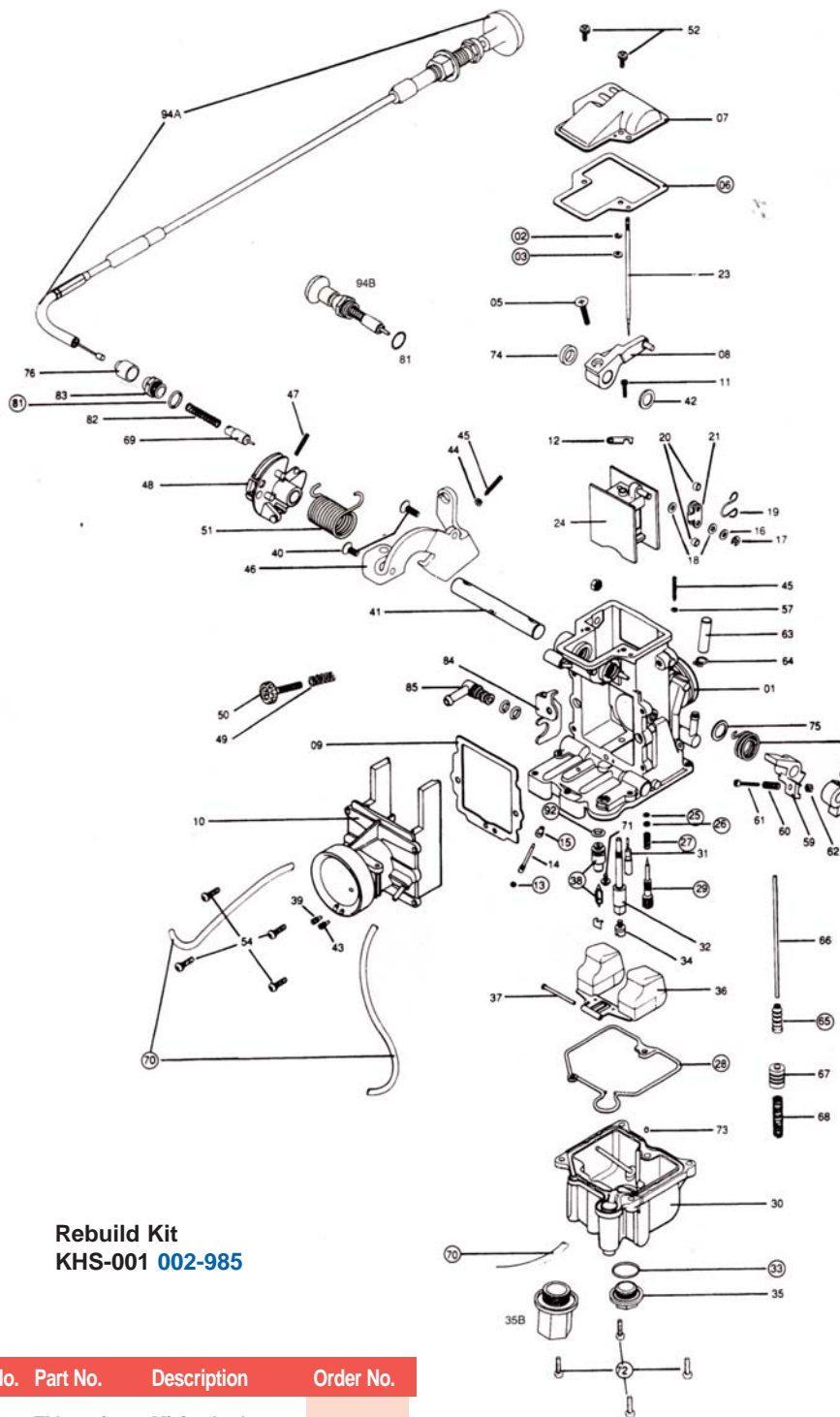

Rebuild Kit  
KHS-001 002-985

No.	Mikuni No.	Description	Order No.
15.	TM29/14	Plug, Nozzle	007-164
16.	M10/56	Washer	002-632
17.	BSW20/70	E-Ring	002-355
18.	B401/10	Packing	002-629
19.	TM27/05A	Clip T.V. Lever	007-761
20.	TM20/65	Ring, T.V. Lever	N/A
21.	TM27/04	Plate, T.V. Lever	N/A
22.	TM36/54	Conn. Plate	007-659
23.	9DJY01	Jet Needle Std.	007-015
24.	TM40/84	Throttle Valve	N/A
25.	N133.037	O-Ring	002-858
26.	VM12/33	Washer	002-856
27.	N133.206	Spring	007-137
28.	619-94021	O-Ring, Float Bowl	007-197
29.	604-26003	Screw	007-138
30.	TM40/12	F.C.B.	007-663
31.	VM28/486	Pilot Jet	Pg. 157
32.	784-13002	Needle Jet (568)	Pg. 155
33.	VM28/254	O-Ring	002-531
34.	N100.604	Main Jet	Pg.156
35.	TM32/41	Drain Plug	007-646
36.	859-32011	Float Ass'y.	007-141
37.	VM30/160	Pin, Float	002-605
38.	786-36011	3.3 N.Valve Ass'y	007-505
38A.	990-786-044-3.8	Needle Valve Assy (40)	002-877
39.	BS30/97	Main Air Jet (plugged)	007-150
40.	C5-0512-B	Screw	N/A
41.	700-15004	Shaft, Throttle	N/A
42.	Packing		
43.	BS30/97	Pilot Air Jet	Pg. 157
44.	N2-03-B	Hex Nut	007-636
45.	TM36/48	Adj. Screw	007-168
46.	TM40/14	Bracket	007-664
47.	N138.019	Pin	007-171
48.	TM40/23	Lever Ass'y.	007-665
49.	N150.025	Spring Idle Adjust	007-633
50.	TM40/91	Adjuster, Idle (Side Idle Only)	007-495
51.	TM36/46A	Spring, Throttle Return	007-204
52.	CW2-0408	Screw	007-175
54.	VM38/133	Screw	N/A
55.	BN38/43	Pin	007-617
56.	TM36/16	Lever	007-657
57.	B30/205	O-Ring	N/A
58.	TM40/33	Spring, A/pump	N/A
59.	TM36/17	Lever	007-292
60.		Spring	002-181
61.	MC-0316	Screw	007-193
62.	N3-03-B	Hex Nut	007-194
63.	N148.013	Cap	002-646
64.	BVK28/128	Spring Clip, Vac Fit	N/A
65.	TM36/64	Cap	007-195
66.	TM36/44	Rod	007-192
67.	TM36/60	Plunger	007-198
68.	VM14SC13/89	Spring	007-200
69.	VM38/148	Plunger	007-203
70.	888-23026	Hose	007-608
71.	VM13/216	Screw	007-174
72.	C2-0412-B	Screw	007-201
73.	VM17/1002	Starter Jet	Pg. 157
74.	VM28/174	Packing, Shaft	
75.	E204040	Ring, A/P Spring	007-628
76.	VM12/43	Cap, Starter Cable	007-676
81.	N138.198	O-Ring	007-160
82.	VM16/42	Spring Starter	002-671
83.	640-12001	Guide Holder	007-161
84.	TM40/26	Plate, Fuel Inlet	N/A
85.	TM40/27	Inlet, Fuel	007-667
92.	KV/10	O-Ring N. Valve	002-709
94.	990-662-001	Choke Cable Ass'y.	007-209
94B.	TM40/07	Choke Knob	007-684

No.	Part No.	Description	Order No.
1.	TM4055/04	Mixing body	002-455
2.	BS32/126	E-Ring	007-267
3.	826-03002	Washer	007-123
4.	739-13001	Allen Screw	007-625
5.	C5-0514	Screw	007-119
6.	TM36/39	Gasket	N/A
7.	TM36/59	Top Cover	N/A
8.	TM36/57	Lever Ass'y	N/A
9.	TM36/42a	Gasket, funnel	N/A
10.	TM40/03	Funnel	N/A
11.	C-0340	Screw, T.V. Platet	N/A
12.	TM36/42	Plate, T.V. Lever	N/A
13.	N124.063	O-ring, Nozzle	007-163
14.	TM36/43	Pump, Nozzle	007-165

**Float Height  
19 mm**

**NOTE:**  
1. Lined through Part numbers are not available.  
2. Parts in **Bold Red** are included in Rebuild Kits.

# MIKUNI HS40

## HS40 (TM40-6) Carburetor Order No. 001-085

### Air Filters

The replacement air filters for the HS Series are K&N Air Filters made especially for the HS Series Carburetors.

<b>ITEM #9</b>	<b>Chrome Air Cleaner Cover</b>	<b>007-215</b>
<b>ITEM #10</b>	<b>Replacement Element Only</b>	<b>007-216</b>

### Cables

Replacement cables for your HS Series Kit.

<b>ITEM #20</b>	<b>Throttle Cable (Pull)</b>	<b>007-210</b>
<b>ITEM #21</b>	<b>Idle Cable (Push)</b>	<b>007-211</b>

(cables available in +6" and 4" shorter)

### Rubber Flange Adapters

Genuine Mikuni rubber flange adapters are available for your Evolution or Sportster/Shovelhead Kit.

<b>ITEM #2</b>	<b>I-VM36-200-1 (HS40-6K)</b>	<b>002-054</b>
<b>ITEM #3</b>	<b>I-VM38-200-1 (HS40-7K)</b>	<b>002-055</b>
	<b>KHS-004 (HS40 ALL)</b>	<b>002-986</b>

### Main Jets

**#50 to #210 N100.604**

Increments of 2.5 (i.e. 160, 162.5, 170, etc.)

### Pilot Jets

**#12.5 to #50 VM28/486**

Increments of .5 (i.e. 20, 22.5, 25, etc.)

### Starter Jets

**#15 to #100 VM17/1002**

### Jet Needles

LEAN ↑	<b>9DJY01 (Standard)</b>	<b>007-015</b>
↕	<b>9DJY02</b>	<b>007-016</b>
RICH ↓	<b>9DJY03</b>	<b>007-017</b>

### HS40 Standard Jetting Spec

<b>Pilot Jet</b>	<b>VM28/486 #17.5</b>	<b>004-029</b>
<b>Pilot Air Jet</b>	<b>BS30/97 #1.1</b>	<b>002-156</b>
<b>Needle Jet</b>	<b>568 Y-6</b>	<b>003-666</b>
<b>Jet Needle</b>	<b>9DJY04-96</b>	<b>007-015</b>
<b>Main Jet</b>	<b>N100.604 #165</b>	<b>004-206</b>

### HS40 Carburetor Adapter for 1990 H-D Models with Standard CV40 Carb

To fit HS40-6K Evolution Carburetor Kit to 1990-on Harley-Davidson models equipped with the Keihin 40mm CV carburetor.

**Order No. 005-095**

### Manifold

<b>Sportster Breather Kit (KHS-010)</b>	<b>002-988</b>
<b>Evo Drop Manifold Kit (KHS-009)</b>	<b>002-987</b>

### Spigot Adapter Ring

**Order No. 005-095**

### Velocity Stacks

Velocity stacks improve the air flow into the carburetors to increase induction efficiency and increase horsepower on racing engines where air filters are not required. Set of 4 velocity stacks fits all Mikuni RS Series Carburetors and other carburetors with 55mm O.D. intake bells. Choose length depending on chassis clearance and desired tuning characteristics (short length—broad high RPM power; medium length—mid RPM power; long length—low RPM POWER).

<b>Length</b>	<b>Order No.</b>
<b>15mm</b>	<b>005-253</b>
<b>30mm</b>	<b>005-250</b>
<b>50mm</b>	<b>005-251</b>
<b>70mm</b>	<b>005-252</b>

### Throttle Valves

**TM40/81 Order No. 007-430**

### HS40 Rebuild Kits

Contains all parts necessary to rebuild the HS40 carb.

**KHS-001 Order No. 002-985**

